

240180 - TORQ-FLEX 180 COMPETITION GOAL

WITH MOUNTING HARDWARE AND ANTI-WHIP NET

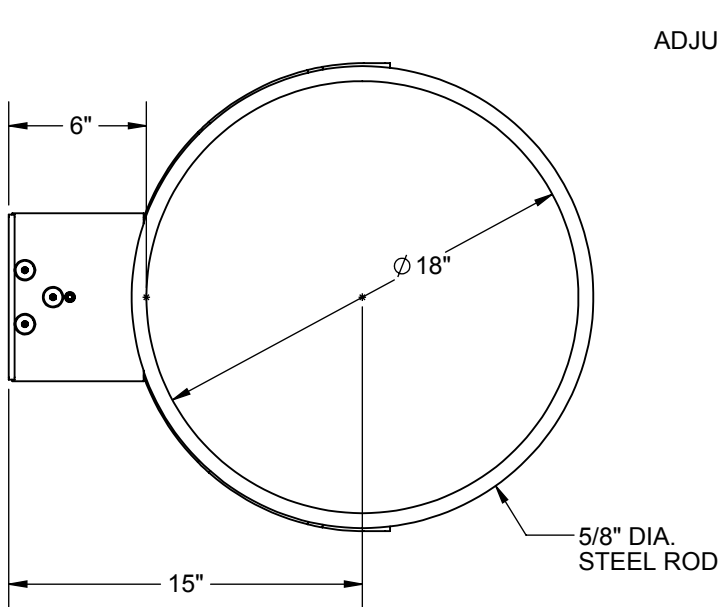

REBOUND/ELASTICITY
ADJUSTED WITH ALLEN WRENCH

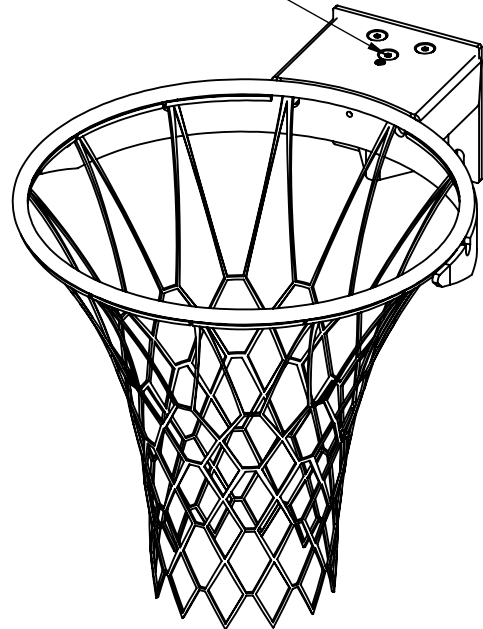

"TUBE-TIE" NET ATTACHMENT SYSTEM ELIMINATES
CONVENTIONAL WIRE FORMED TYPE NET HOOKS

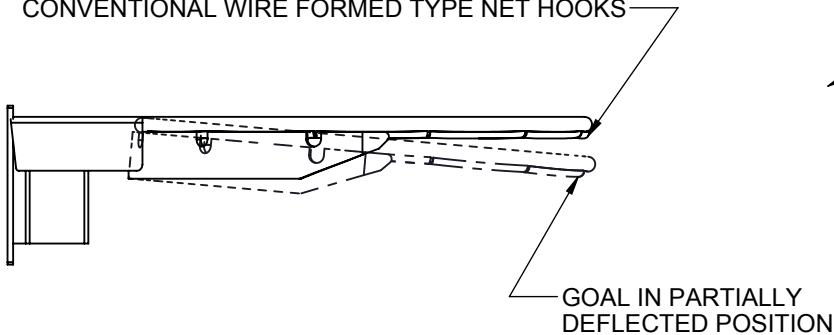

GOAL MOUNTING PLATE

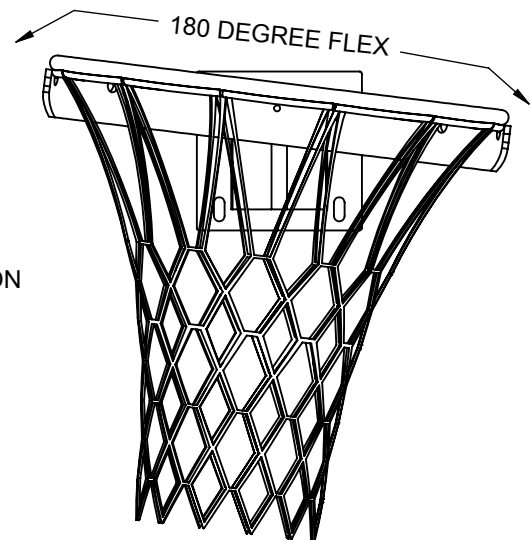
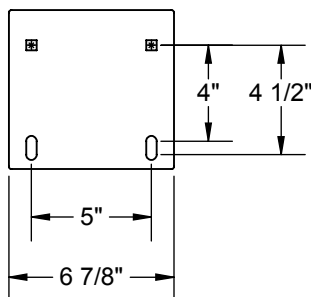

- 240180 FLEX GOAL WITH MOUNTING HARDWARE AND ANTI-WHIP NET
SEE B-200 FOR COMPATABLE BACKBOARDS

240180 - TORQ-FLEX 180 COMPETITION GOAL

WITH MOUNTING HARDWARE AND ANTI-WHIP NET

SPECIFICATIONS

Shock absorption feature shall be provided by means of a special, offset ball bearing pivot about which the rim shall pivot around the goal housing. The pivot point shall be positioned to place goal return impact forces in shear (parallel) to minimize oscillation induced into the face of the backboard. Front of rim shall deflect downward when a static load is applied and instantly return to playing position when load is released.

Goal shall incorporate a multi spring design to allow the goal to flex in a complete 180 radius as players hang on the front or sides of the rim. Spring mechanism shall be easily adjustable to meet rebound/elasticity needs. Non-adjustable goals, goals pivoting in only one plane, or goals incorporating shock absorber type mechanisms shall not be considered as equal.

Function of goal shall meet the NCAA specifications on moveable rims, which states "A moveable basket ring shall have rebound characteristics identical to those of a non-moveable ring." Goal shall be set at factory for proper flex and rebound requirements.

Rim shall be fabricated from 5/8" diameter cold drawn alloy steel, round formed to an 18" inside diameter ring. Inside diameter of ring shall be positioned 6" from face of backboard by a heavy formed steel housing with a removable bottom cover to conceal spring mechanisms of goal, and also protect against finger entrapment. Goal mounting plate shall be provided with hardware and a 5" x 4" to 5" x 4.5" mounting hole pattern for front mounting on standard glass, wood and fiberglass type backboards and is also compatible for use with all Center-Strut direct mount type support frames.

Rim shall be rigidly braced by means of a formed steel brace welded in position on the underside of the rim for maximum support. Rim shall be provided with a "tube-tie" net attachment system to eliminate the conventional wire-formed type net locks for additional player safety.

Goal shall be furnished in a durable, official orange powder-coat finish.

Goal shall be furnished complete with plated mounting hardware and an anti-whip net.

For details on compatible backboards see B-200.

WARRANTY

- 240180 goal furnished with a 5-year limited warranty.